

THREADED COPPER BARS

Cu-ETP UNI EN 13601 copper busbars

Flat copper bars – 1 mm radius edge

Tin-plated, silver-plated and nickel-plated on demand

Special lengths and dimensions on demand

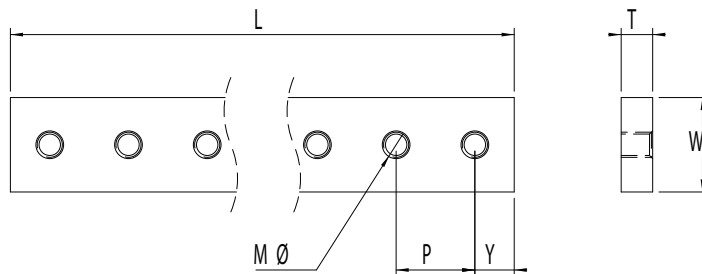

Code	Cross section	W x T	L	P	Y	threaded hole	Current load at ΔT	
	mm ²	dimensions in mm.					°30 ΔT C	°50 ΔT C
CTB 12-2/1	24	12x2	990	18	9	M5	106	142
CTB 12-4/1	48	12x4	990	18	9	M5	160	210
CTB 12-5/1	60	12x5	990	18	9	M5	182	240
CTB 15-4/1	60	15x4	1000	20	10	M6	188	248
CTB 15-5/1	75	15x5	1000	25	12,5	M6	216	286
CTB 20-4/1	80	20x4	1000	20	10	M6	230	304
CTB 20-5/1	100	20x5	1000	25	12,5	M6	274	362
CTB 25-4/1	100	25x4	1000	20	10	M6	288	380
CTB 30-5/1	150	30x5	1000	25	12,5	M6	378	502
CTB 32-5/1	160	32x5	1000	25	12,5	M6	400	530
CTB 30-10/1	300	30x10	1000	25	12,5	M8	572	754
CTB 12-2/2	24	12x2	1998	18	9	M5	106	142
CTB 12-4/2	48	12x4	1998	18	9	M5	160	210
CTB 12-5/2	60	12x5	1998	18	9	M5	182	240
CTB 15-4/2	60	15x4	2000	20	10	M6	188	248
CTB 15-5/2	75	15x5	2000	25	12,5	M6	216	286
CTB 20-4/2	80	20x4	2000	20	10	M6	230	304
CTB 20-5/2	100	20x5	2000	25	12,5	M6	274	362
CTB 25-4/2	100	25x4	2000	20	10	M6	288	380
CTB 30-5/2	150	30x5	2000	25	12,5	M6	378	502
CTB 32-5/2	160	32x5	2000	25	12,5	M6	400	530
CTB 30-10/2	300	30x10	2000	25	12,5	M8	572	754