

ELEXOPOWER INSULATED COPPER BRAIDS

bare/tinned copper braid– tinned terminals



Tin-plated copper tube terminals:
Single Wire:
Black PVC insulation Self extinguishing:
Operating voltage:
Operating temperature:
Dielectric strenght:
Insulation thickness:

Cu-DHP UNI EN 12449
Cu-ETP UNI EN 13602 - Ø 0,20 mm
UL 94 V0
1000 V AC – 1500 V DC
-40/+105°C
20 kV/mm
1,6 – 2mm

Current loads referred to rise temperature ΔT following IEC 439 norm – Ta (Amb.Temp.) 35°C

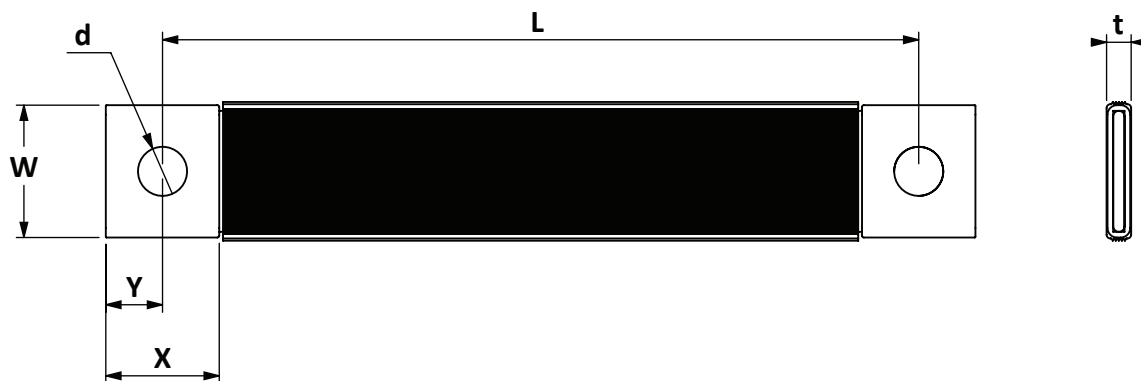

Bare Copper braid	Tinned Copper braid	Cross Section	L	W	X	Y	t	d Ø	Current load		
tinned terminals	tinned terminals	mm ²	dimensions in mm						ΔT 30°C	ΔT 50°C	ΔT 70°C
IRT 16/020-L/12	ITT 16/020-L/12	16	230-330-430-530-630 730-830-930-1030	12	14	7	3	6,5	93 A	127 A	153 A
IRT 25/020-L/12	ITT 25/020-L/12	25	230-330-430-530-630 730-830-930-1030	12	14	7	5	6,5	120 A	160 A	200 A
IRT 25/020-L/20	ITT 25/020-L/20	25	230-330-430-530-630 730-830-930-1030	20	22	10	3,7	9-11	128 A	178 A	220 A
IRT 35/020-L/20	ITT 35/020-L/20	35	230-330-430-530-630 730-830-930-1030	20	22	10	4,5	9-11	153 A	212 A	260 A
IRT 50/020-L/20	ITT 50/020-L/20	50	230-330-430-530-630 730-830-930-1030	20	22	10	5,5	11	187 A	260 A	320 A
IRT 75/020-L/20	ITT 75/020-L/20	75	230-330-430-530-630 730-830-930-1030	20	22	10	7	11	238 A	320 A	400 A
IRT 120/020-L/32	ITT 120/020-L/32	120	230-330-430-530-630 730-830-930-1030	32	32	15	7	11	340 A	460 A	565 A
IRT 240/020-L/32	ITT 240/020-L/32	240	230-330-430-530-630 730-830-930-1030	32	32	15	12	13	500 A	680 A	840 A

ELEXOPOWER HF INSULATED COPPER BRAIDS

bare/tinned copper braid - tinned terminals - halogen free



Tin-plated copper tube terminals:
Single wire:
TPE insulation Self extinguishing:
Operating voltage:
Operating temperature:
Dielectric strenght:
Insulation thickness:

Cu-DHP UNI EN 12449
Cu-ETP UNI EN 13602 - Ø 0,20 mm
Halogen Free
1000 V AC – 1500 V DC
-40/+140°C
20 kV/mm
1,2 – 1,8 mm

Current loads referred to rise temperature ΔT following IEC 439 norm – Ta (Amb.Temp.) 35°C

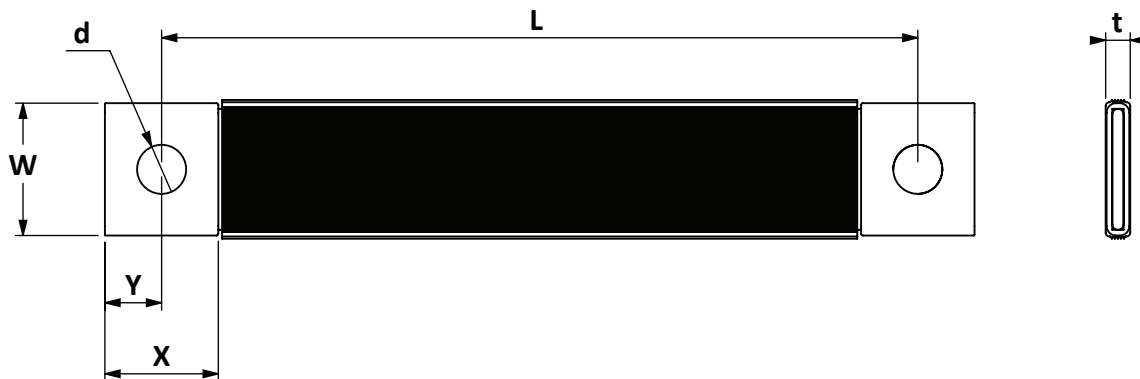

Bare Copper braid	Tinned Copper braid	Cross Section	L	W	X	Y	t	d Ø	Current load		
tinned terminals	tinned terminals	mm ²	dimensions in mm						ΔT 30°C	ΔT 50°C	ΔT 70°C
IRT 16/020-L/12 HF	ITT 16/020-L/12 HF	16	230-330-430-530-630 730-830-930-1030	12	14	7	3	6,5	93 A	127 A	153 A
IRT 25/020-L/12 HF	ITT 25/020-L/12 HF	25	230-330-430-530-630 730-830-930-1030	12	14	7	5	6,5	120 A	160 A	200 A
IRT 25/020-L/20 HF	ITT 25/020-L/20 HF	25	230-330-430-530-630 730-830-930-1030	20	22	10	3,7	9-11	128 A	178 A	220 A
IRT 35/020-L/20 HF	ITT 35/020-L/20 HF	35	230-330-430-530-630 730-830-930-1030	20	22	10	4,5	9-11	153 A	212 A	260 A
IRT 50/020-L/20 HF	ITT 50/020-L/20 HF	50	230-330-430-530-630 730-830-930-1030	20	22	10	5,5	11	187 A	260 A	320 A
IRT 75/020-L/20 HF	ITT 75/020-L/20 HF	75	230-330-430-530-630 730-830-930-1030	20	22	10	7	11	238 A	320 A	400 A
IRT 120/020-L/32 HF	ITT 120/020-L/32 HF	120	230-330-430-530-630 730-830-930-1030	32	32	15	7	11	340 A	460 A	565 A
IRT 240/020-L/32 HF	ITT 240/020-L/32 HF	240	230-330-430-530-630 730-830-930-1030	32	32	15	12	13	500 A	680 A	840 A

ELEXOPOWER R HF INSULATED COPPER BRAIDS

bare/tinned copper braid - tinned terminals - halogen free - rounded terminals



Tin-plated copper tube terminals:
Single wire:
TPE insulation Self extinguishing:
Operating voltage:
Operating temperature:
Dielectric strenght:
Insulation thickness:

Cu-DHP UNI EN 12449
Cu-ETP UNI EN 13602 - Ø 0,20 mm
Halogen Free
1000 V AC – 1500 V DC
-40/+140°C
20 kV/mm
1,2 – 1,8 mm

Current loads referred to rise temperature ΔT following IEC 439 norm – Ta (Amb.Temp.) 35°C

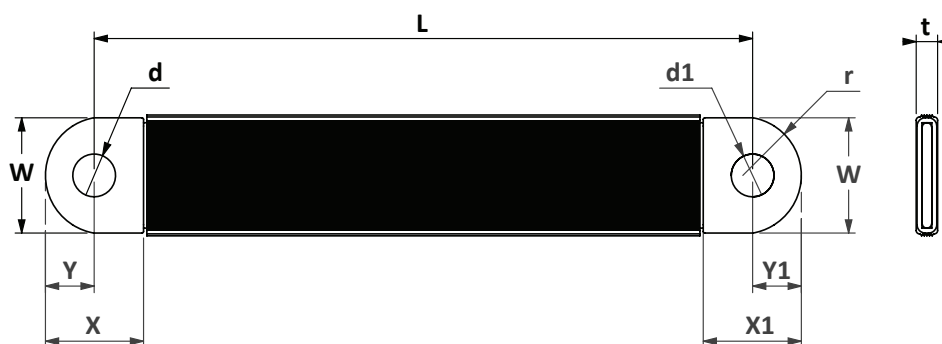

Bare Copper braid	Tinned Copper braid	Cross Section	L	W	X	Y	d Ø	X1	Y1	d1 Ø	t	Current load		
tinned terminals	tinned terminals	mm ²	dimensions in mm									ΔT 30°C	ΔT 50°C	ΔT 70°C
IRT 16/020-L/12 R HF	ITT 16/020-L/12 R HF	16	230-330-430-530-630 730-830-930-1030	12	14	6,5	6,5	14	6,5	6,5	3	93 A	127 A	153 A
IRT 25/020-L/12 R HF	ITT 25/020-L/12 R HF	25	230-330-430-530-630 730-830-930-1030	12	14	6,5	6,5	14	6,5	6,5	5	120 A	160 A	200 A
IRT 25/020-L/20 R HF	ITT 25/020-L/20 R HF	25	230-330-430-530-630 730-830-930-1030	20	22	10	8,5	22	12	10,5	3,7	128 A	178 A	220 A
IRT 35/020-L/20 R HF	ITT 35/020-L/20 R HF	35	230-330-430-530-630 730-830-930-1030	20	22	10	8,5	22	12	10,5	4,5	153 A	212 A	260 A
IRT 50/020-L/20 R HF	ITT 50/020-L/20 R HF	50	230-330-430-530-630 730-830-930-1030	20	22	9	8,5	22	11	10,5	5,5	187 A	260 A	320 A
IRT 75/020-L/20 R HF	ITT 75/020-L/20 R HF	75	230-330-430-530-630 730-830-930-1030	20	22	9	8,5	22	11	10,5	7	238 A	320 A	400 A
IRT 120/020-L/32 R HF	ITT 120/020-L/32 R HF	120	230-330-430-530-630 730-830-930-1030	32	32	11	10,5	32	11	10,5	7	340 A	460 A	565 A
IRT 240/020-L/32 R HF	ITT 240/020-L/32 R HF	240	230-330-430-530-630 730-830-930-1030	32	32	12	10,5	32	14	12,5	12	500 A	680 A	840 A